

An aerial photograph of a modern architectural complex. In the foreground, a large, circular building with a distinctive heart-shaped roof sits on a grassy hillside. A winding road curves around the building. In the background, a calm lake reflects the sky, with rolling hills and distant industrial structures visible on the horizon. The overall atmosphere is serene and natural.

# the lake

By PLACEMAKERS



We want to create a different

# Lifestyle

The Lake is owned, created, and developed by Placemakers, a Georgia-based real estate development company known for designing thoughtful, human-centered environments that elevate everyday living.

When you live by the lake, you are not simply buying a house, but an entire Lifestyle.



By PLACEMAKERS



# Project Description

- 13.5 ha exclusive land plot
- 20 land plots from 1000 to 1300 m<sup>2</sup>
- 49 Individually Designed Villas
- Expat oriented 21 Private Houses





the lake  
by PLACEMAKERS



by PLACEMAKERS



the lake  
by PLACEMAKERS

By PLACEMAKERS





the lake

BY PLACEMAKERS

BY PLACEMAKERS

LISI LAKE



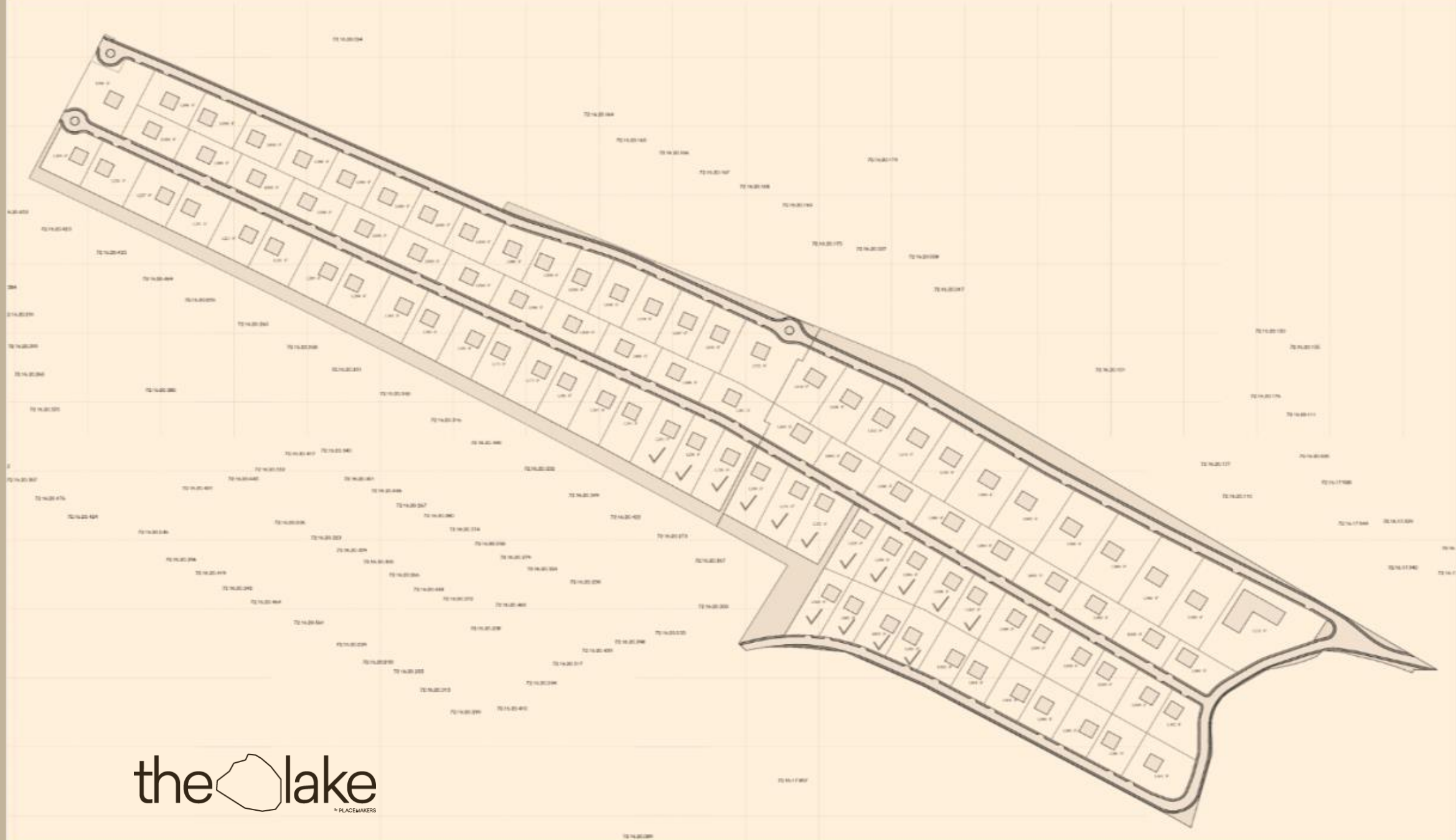



the lake



BY PLACE MAKERS



the lake  
by PLACEMAKERS

By PLACEMAKERS





# Exclusive Villa district next to the Lisi Lake

Large-scale project, with investment of up to 50 million dollars, financed by TBC Bank, with international partnership that developed strong team both in financial and execution terms .





# Exclusive Villa district next to the Lisi Lake

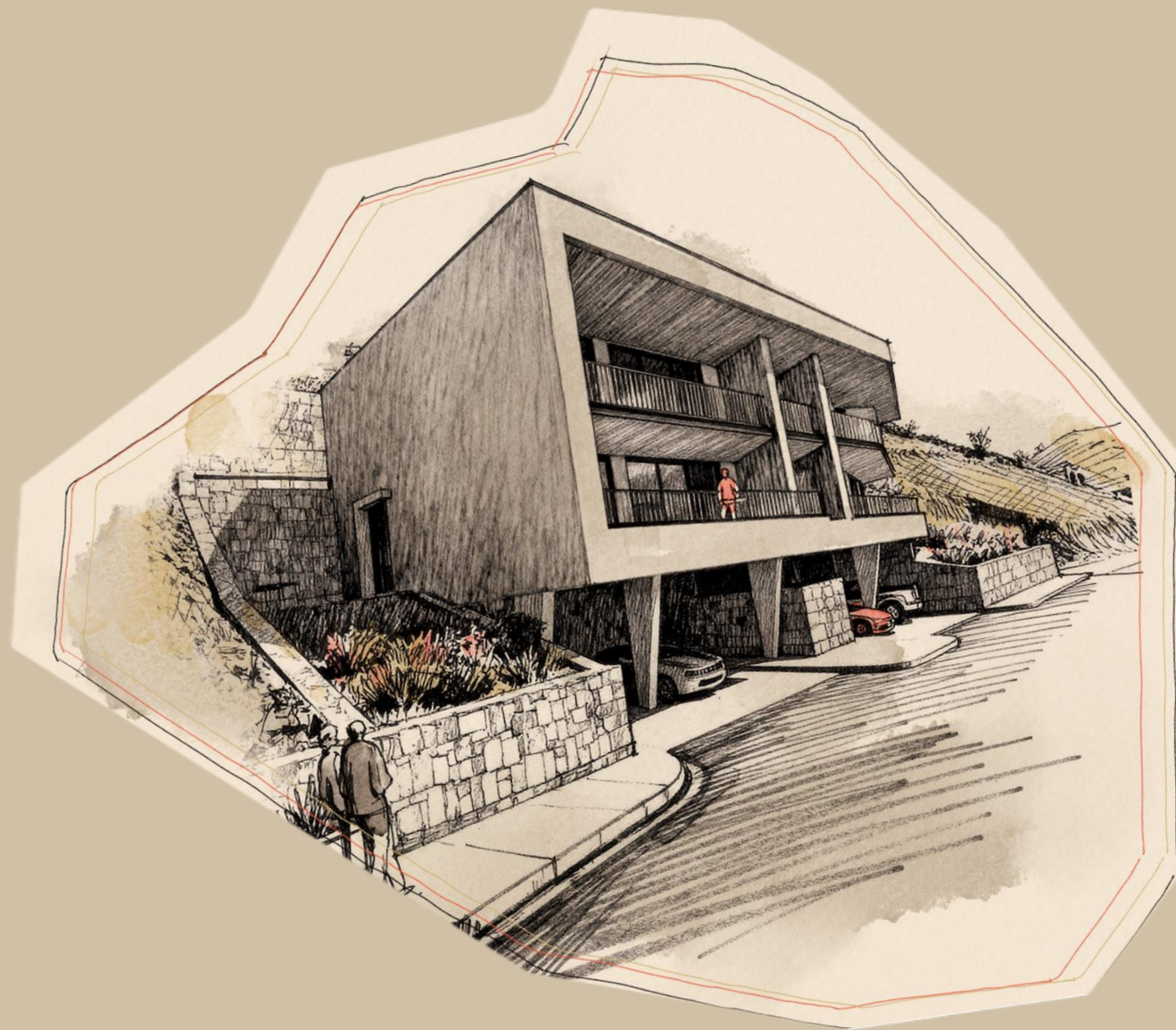

By PLACEMAKERS



# Exclusive Villa district next to the Lisi Lake



By PLACEMAKERS





# DESIGN & ARCHITECTURE

Our goal is to create a living environment that differs from all others, where every detail is defined by the standards of modern urban life – from functional layouts and infrastructure to spaces designed for leisure and activities.



By PLACEMAKERS



The design concept of The Lake was born directly from the location – the lake and the natural landscape defined the character of the space.

Our goal is ,to blend architecture as much as possible into the environment and for the exterior to flow into the interior





# Lake House by Snøhetta

The main “heartbeat” of The Lake will be Lake House – not only the center of the complex, but also a new attraction point for Tbilisi. This building occupies a special place in Placemakers’ vision: it is not infrastructure designed exclusively to serve the needs of residents. Lake House’s role is much broader – to become a space where district residents, their guests, and the rest of the city meet. At the same time, residents and club members will enjoy special offers and access to certain dedicated spaces.



Snøhetta



# Lake House by Snøhetta



By PLACEMAKERS



# Lake House by Snøhetta





# Lake House by Snøhetta





# Lake House by Snøhetta







For more information:

[info@placemakers.ge](mailto:info@placemakers.ge)

+995 511553333

15 D Tuta str, Tbilisi , Georgia

---